

NEW  
Renault TRIBER  
Space for everything







# NEW Renault **TRIBER** Space for everything



The more the merrier. In India, this is not just a motto, it's a norm. At home, work or play, we enjoy everything with larger groups and our ever-growing social circles. Today, with so much more to do, we seek even more space for our passions, hobbies and experiences.

Be it a short drive to a concert, a trip to go surfing or a long vacation with the tribe, what India needs is a car that can accommodate both, people and plans. Which is why the new Renault TRIBER is here. As India's most spacious sub-4m car, the ultra modular TRIBER gives you surprising flexibility and more space for everyone, every experience and everything.





Stylish Flex Wheels | Wheel Arch Claddings



Roof Rails with Load Carrying Capacity

## ROBUST AND ATTRACTIVE

The new Renault TRIBER is sure to catch attention with its striking Projector Headlamps, Stylish Roof Rails and LED DRLs. The 3-part ultra-modern Triple Edge Chrome Front Grille and Stylish Flex Wheels further add to its presence. A Ground Clearance of 182 mm and SUV Skid Plates lend an impressive stance while offering protection on rough roads.

# STYLING



Eagle Beak Split Tail Lamps



SUV Skid Plates



High Ground Clearance



Triple Edge Chrome Front Grille | Projector Headlamps with LED DRLs





Unmatched Space in all Rows with Slide and Recline 2<sup>nd</sup> Row Seats



Cooled Storage in Centre Console

# SUPER SPACIOUS

The new Renault TRIBER has been thoughtfully designed to accommodate comfort and convenience. It features the best-in-class passenger cabin space available in a sub-4m car, a best-in-class boot space of 625 litres (in Life Mode) and interior storage of up to 31 litres. Go ahead, discover space like never before.



625 Litre Boot Space



Upper and Cooled Lower Glove Box





**LIFE MODE**  
5-SEATER

This default mode gives lots of space for 5 people and a best-in-class 625 litre boot space. So that you can carry all your luggage, barbecue set or camping gear effortlessly.



**ULTRA**

# MODULAR

The new Renault TRIBER's space is smartly optimised with four exciting modes and 100+ seating combinations to give you all the space you need for your tribe and new experiences.



**TRIBE MODE**  
7-SEATER

Click in two additional EasyFix Seats and you're all set to carry the entire tribe in style.



**CAMP MODE**  
2-SEATER

Maximum boot space to huddle up, play board games or even relax inside the car.



**SURF MODE**  
4-SEATER

Additional space to accommodate more things or things that take up more length, like a musical instrument or an extra haversack.







# MODERN AND WELL-EQUIPPED INTERIORS

Experience all-new modern interiors inside the new Renault TRIBER. The dual tone interiors with harmonious trims exude warmth while the new Centre Fascia with sleek chrome edges spells sophistication. The super spacious TRIBER features a stylish dual tone dashboard with silver accents, an LED Instrument Cluster and a Twin AC with vents on 2<sup>nd</sup> and 3<sup>rd</sup> rows. Its easy-to-use MediaNav Evolution touchscreen comes integrated with Android Auto, Apple CarPlay, Push-to-Talk and Video Playback on your screen. The smart technology continues in the Smart Access Card with keyless entry and the Push Start-Stop Button, to further enhance your driving experience.



Smart Access Card



Twin AC with Vents on 2<sup>nd</sup> and 3<sup>rd</sup> Row



Push Start-Stop Button



LED Instrument Cluster



2 Front Airbags (Driver and Passenger) + 2 Side Airbags (Front Seats)

Best-in-class

Apple CarPlay  
androidauto

Android Auto is a trademark of Google LLC

20.32 cm Touchscreen MediaNAV Evolution | Stylish Dual Tone Dashboard with Silver Accents



NEW



# ENGINE

The new Renault TRIBER offers a perfect balance of performance and fuel economy. Its peppy 1.0-litre 3-cylinder petrol Energy Engine generates 72 PS with 96 Nm torque. Further equipped with modern technology like the dual VVT system that delivers maximum response at all revs, it ensures optimum acceleration. This along with good fuel efficiency and low maintenance cost makes the engine ideal for India. The TRIBER is available in 5-speed manual transmission.

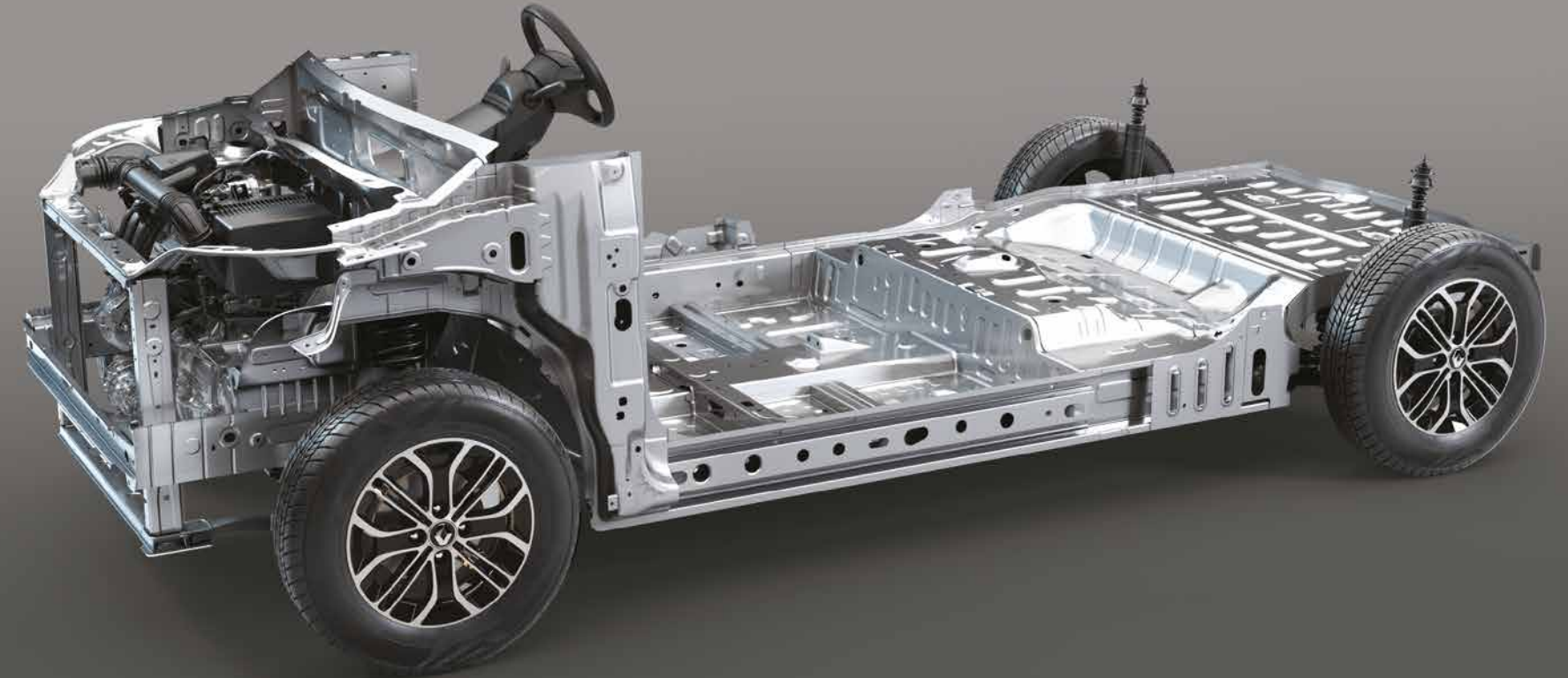

NEW UNIQUE

# PLATFORM

The new Renault TRIBER is designed on a unique and latest generation modular platform. This offers unbeatable roominess and flexibility. With an optimised engine compartment, it helps maximise space in the passenger compartment. The new platform also provides a superior driving experience and unmatched comfort.

EASY IN. EASY OUT.



# EASYFIX SEATS

The new Renault TRIBER comes with first-in-industry innovative EasyFix Seats. These two additional seats can be clicked in or out of the third row, transforming the TRIBER into a 6-seater or a 7-seater instantly. Now, carry your entire group along.

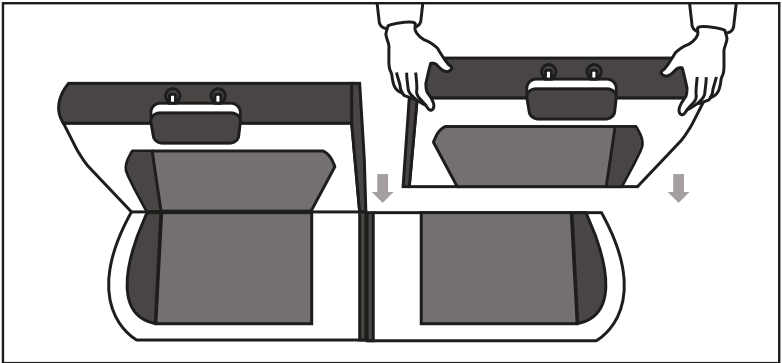
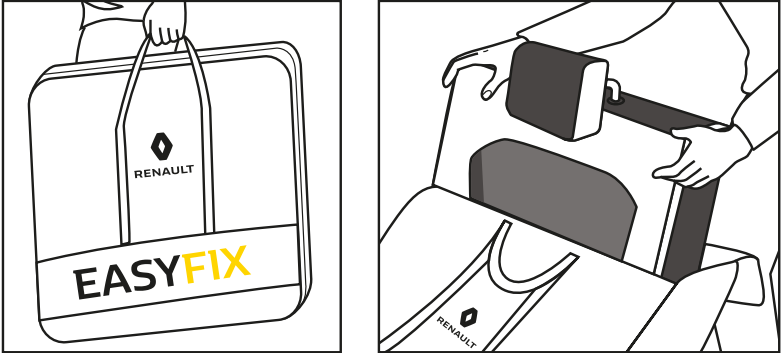

## RXE

### EXTERIOR DESIGN:

- Projector Headlamps
- Wheel Arch Cladding
- Body Colour Bumper
- Wheel Center Cap
- Black ORVM
- Black Door Handle

### INTERIOR DESIGN:

- Dual Tone Dashboard
- Black Inner Door Handles
- LED Instrument Cluster - Amber Colour
- Meson Black Fabric Upholstery

### COMFORT:

- Electric Power Steering
- On Board Computer
- Front Power Windows
- Air Conditioning Vents - 1<sup>st</sup> Row Only
- 2<sup>nd</sup> Row Seats - Slide/Recline/Fold & Tumble Function
- EasyFix Seats: Fold/Tumble Function
- 60:40 Split 2<sup>nd</sup> Row Seat
- Electric Tail Gate Release on Center Console
- Open Storage on Center Console
- 12V Socket - 1<sup>st</sup> Row Only

### SAFETY:

- Front Airbag - Driver & Passenger
- ABS + EBD
- Load Limiter + Pretensioner (Driver Only)
- Speed Alert Warning
- Seat Belt Reminder - Driver + Passenger
- Rear Parking Sensor
- Pedestrian Protection

### POWERTRAIN:

- Energy Engine
- Manual Transmission

## RXL = RXE+

### EXTERIOR DESIGN:

- Body Colour Door Handle
- Full Plastic Wheel Cover
- Black Decal on Door
- Black Coloured B & C Pillar
- Body Colour ORVM
- Front Grille with Chrome Insert

### INTERIOR DESIGN:

- Dual Tone Dashboard with Piano Black Finish
- LED Instrument Cluster - White Colour
- Side Air Vents with Satin Outline
- Instrument Cluster with Satin Semi-Outline

### COMFORT:

- Height Adjust Tilt Steering
- Twin AC with 2<sup>nd</sup>/3<sup>rd</sup> Row Vents and Independent Control

- Rear Assist Grips on 2<sup>nd</sup> & 3<sup>rd</sup> Row
- Cooled Storage in Center Console
- Remote Central Locking
- ORVM - Manual Internal Adjust
- R&GO Audio System with Bluetooth & USB Connection
- 2 Front Speakers

### SAFETY:

- Speed Sensing Door Lock
- Impact Sensing Unlock

### POWERTRAIN:

- Energy Engine
- Manual Transmission

## RXT = RXL+

### EXTERIOR DESIGN:

- Triple Edge Chrome Front Grille
- Roof Rails with Load Carrying Capacity (50kg)
- SUV Skid Plates - Front & Rear

### INTERIOR DESIGN:

- Air Vents (Front side) with Chrome
- LED Instrument Cluster with Chrome Semi Outline
- HVAC Knobs with Chrome Ring
- Japda Fabric Upholstery

### COMFORT:

- ORVM - Electrical Adjust
- Rear Power Windows
- Front Seat back pocket - Passenger & Driver Side
- MediaNAV with 20.32 cm Touchscreen
- 2 Rear Speakers

- Day & Night Adjustable IRVM
- Rear Room Lighting
- Upper Glove Box
- Cooled Lower Glove Box
- Seat Drawer Under Driver seat
- Vanity Mirror - Passenger Side
- 12V Socket - 2<sup>nd</sup> Row

### POWERTRAIN:

- Energy Engine
- Manual Transmission

## RXZ = RXT+

### EXTERIOR DESIGN:

- Styled Flex Wheels
- LED DRL

### INTERIOR DESIGN:

- Dual Tone Dashboard with Silver Accents
- Chrome Finished Parking Brake Button, Knobs on Front Air Vents, Push Button Surround
- Piano Black Finish Around MediaNAV Evolution
- Silver Finish - Inner Door Handles, Gear Knob, Steering Wheel Insert
- 3D Spacer Fabric Upholsetry

### COMFORT:

- 2 Front Tweeters
- Smart Access Card
- Push Button Start / Stop
- Rear Wiper, Washer & Defogger
- Auto Up Down - Driver Window
- Rear View Camera
- Vanity Mirror - Driver Side
- 12V Socket - 3<sup>rd</sup> Row

### SAFETY:

- 2 Side Airbags (Front Seats)

### POWERTRAIN:

- Energy Engine
- Manual Transmission

# TRIBER KEY FEATURES



	RXE	RXL	RXT	RXZ
ENGINE & TRANSMISSION		ENERGY		
Displacement (cc)	999			
Number of Cylinders	3			
Maximum Power Output (PS)	72PS @ 6250RPM			
Maximum Torque (Nm)	96Nm @ 3500RPM			
Transmission type	Manual			
Fuel System	Multi Point Fuel Injection			
STEERING				
Type	Electric Power Steering			
SUSPENSION				
Front	McPherson Strut with Lower Triangle & Coil Spring			
Rear	Torsion Beam Axle			
BRAKE				
Front	Disc			
Rear	Drum			
TYRES				
Tyres	165/80/R14		185/65/R15	
DIMENSIONS & CAPACITIES				
Overall length (mm)	3990			
Overall Width Without Mirror (mm)	1739			
Overall Height Without Roof Rails (mm)	1643			
Wheel Base (mm)	2636			
Front Track (mm)	1547		1527	
Rear Track (mm)	1545		1525	
Fuel Tank Capacity (L)	40			
Ground Clearance (mm)	182			
Boot Space (L)				
Life Mode	625			
Tribe Mode	84			



METAL MUSTARD



ELECTRIC BLUE



FIERY RED



MOONLIGHT SILVER



ICE COOL WHITE



**RENAULT**  
Passion for life



**www.renault.co.in**  
Call: **1800 315 4444**  
SMS **TRIBER** to **53030**

Every precaution has been taken to ensure that this publication is accurate and up-to-date on the date it is printed. This document has been created on the basis of pilot lots and prototypes. As part of its ongoing product improvement policy, Renault India Pvt. Ltd., reserves the right to modify the specifications, vehicles and accessories described and shown at any time. Such modifications are communicated to Renault dealers as quickly as possible. Depending on the country of sale, certain versions may differ and certain equipments may be unavailable (as standard, optional or accessory). Please contact your nearest dealer for the latest information. Due to printing limitations, the colours that appear in this document may differ slightly from the actual paint or upholstery colours. All rights are reserved. The reproduction in any format and by any means of all or part of this publication without prior written authorisation from Renault is prohibited. Segment definition based on Renault internal classification.

Scan with your phone  
camera to  
explore the TRIBER

